

Stereo Sound System

Component Location Index



CAUTION:

- All SRS wiring harnesses are covered with yellow outer insulation.
- Before disconnecting any part of the SRS wire harness, install the short connectors (see page 23-409).
- Replace the entire affected SRS harness assembly if it has an open circuit or damaged wiring.

NOTE: The original radio has a coded theft protection circuit. Be sure to get the customer's code number before

- disconnecting the battery.
- removing the No. 56 (7.5 A) fuse from the under-hood fuse/relay box.
- removing the radio.

After service, reconnect power to the radio and turn it on. When the word "CODE" is displayed, enter the customer's 5-digit code to restore radio operation.

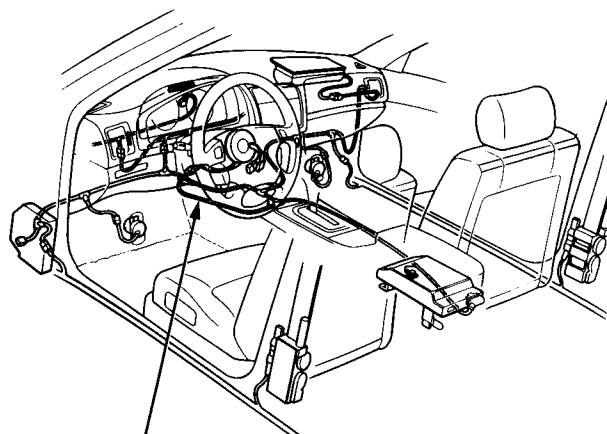

SRS MAIN HARNESS
(Covered with yellow outer insulation)

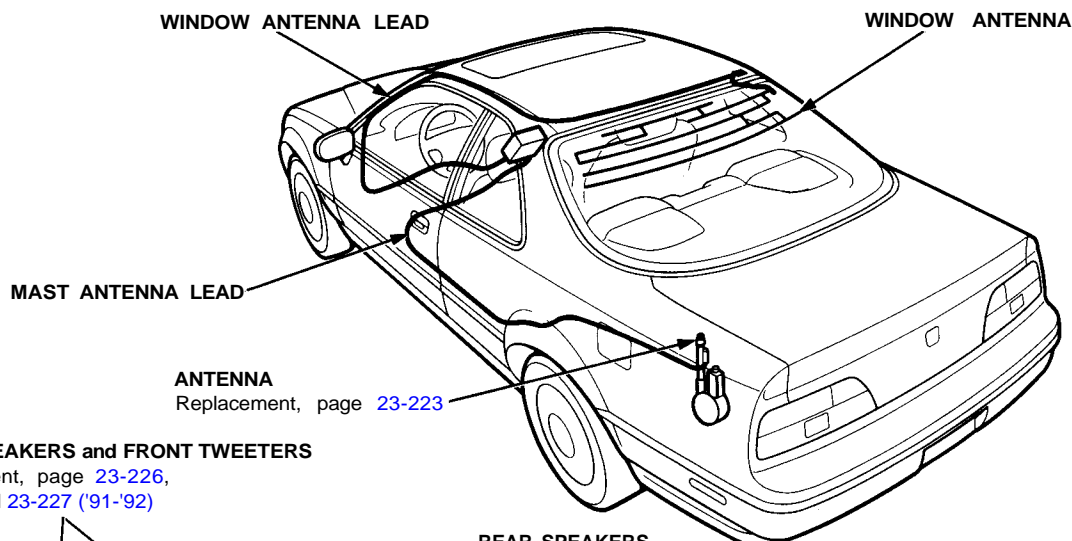

WINDOW ANTENNA LEAD

WINDOW ANTENNA

MAST ANTENNA LEAD

ANTENNA
Replacement, page 23-223

DOOR SPEAKERS and FRONT TWEETERS

Replacement, page 23-226,
23-226 and 23-227 ('91-'92)

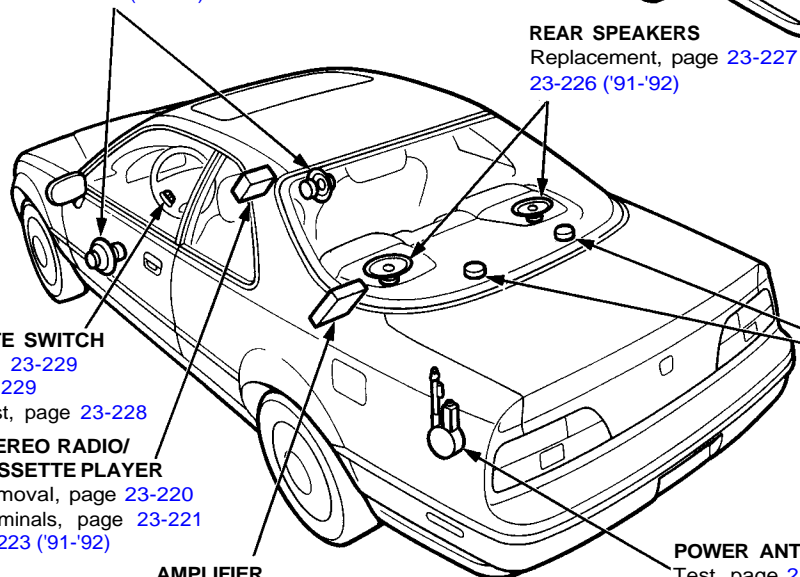

REAR SPEAKERS
Replacement, page 23-227
23-226 ('91-'92)

REAR TWEETERS
Replacement, page 23-227
('91-'92) ('93-'95)

RADIO REMOTE SWITCH
Removal, page 23-229
Test, page 23-229
Cable Reel Test, page 23-228

**STEREO RADIO/
CASSETTE PLAYER**
Removal, page 23-220
Terminals, page 23-221
23-223 ('91-'92)

AMPLIFIER
Terminals, page 23-225
Removal, page 23-224

POWER ANTENNA MOTOR
Test, page 23-222
Replacement, page 23-224